

END-FITTINGS



ArvinMeritor Gas Springs offer a wide range of end fittings that will enhance your application. Manufactured from a range of finishes and materials including nylon, steel and zinc, they will give many years of trouble-free operation. End fittings can be both the same or you can choose different sizes and types for each end. Flexibility is what ArvinMeritor Gas Springs offers you.

If you have any questions about specifying your ArvinMeritor Gas Spring, please call our sales office on 0116 274 3622 / 3623.

Benefits

- Many different designs and sizes for flexibility of mounting
- Range of materials and finishes
- Designed to enhance your application
- Maintenance free
- BS EN ISO 9001 Registered Company

Gas Spring Part Numbering example

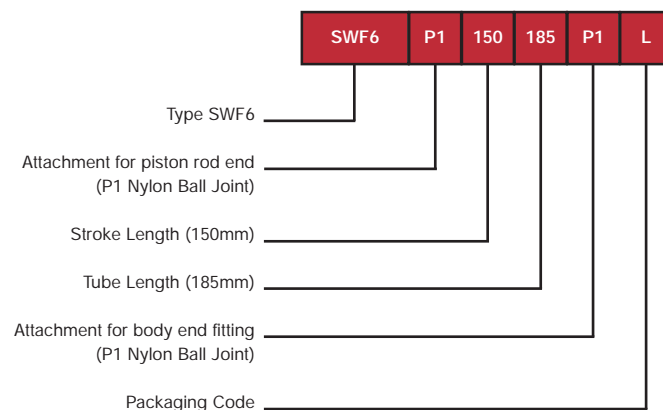

Nylon Ball Joints

	P1	P2	P5	P7	P8	PA
J (+/-)	9.0mm 0.5mm	14.0mm 0.5mm	12.0mm 0.5mm	NO PIN	NO PIN	14.0mm 0.5mm
K (+/-)	10.3mm 0.25mm	9.0mm 0.2mm	12.5mm 0.5mm			9.0mm 0.2mm
G	M5 x 0.8	M5 x 0.8	M8 x 1.25			M5 x 0.8
C	M5 x 0.8	M5 x 0.8	M6 x 1.0	M5 x 0.8	M6 x 1.0	M6 x 1.0
L (+/-)	17.5mm 0.5mm	17.5mm 0.25mm	17.5mm 0.5mm	17.5mm 0.5mm	17.5mm 0.5mm	17.5mm 0.5mm

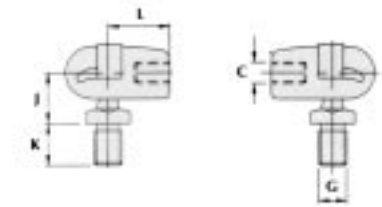

Nylon Eyes

	E1	E2	E3	E4	E5
E (+/-)	6.1mm 0.08mm	8.0mm 0.08mm	8.1mm 0.05mm	6.1mm 0.05mm	10.1mm 0.05mm
M (+/-)	8.1mm 0.05mm	7.0mm 0.2mm	10.0mm 0.12mm	10.0mm 0.12mm	10.0mm 0.12mm
L (+/-)	17.0mm 0.5mm	17.0mm 0.5mm	21.0mm 0.25mm	21.0mm 0.25mm	21.0mm 0.25mm
C	M5 x 0.8	M5 x 0.8	M6 x 1.0	M6 x 1.0	M6 x 1.0

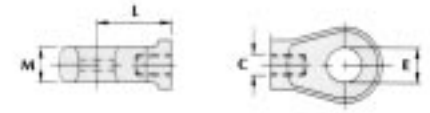

Flat Steel Eyes

	F1	F2	F3	F4	FD
E (+/-)	6.1mm 0.12mm	8.1mm 0.12mm	10.2mm 0.25mm	8.2mm 0.12mm	10.2mm 0.12mm
M (+/-)	3.0mm 0.12mm	5.0mm 0.12mm	5.0mm 0.12mm	8.0mm 0.12mm	10.0mm 0.12mm
L (+/-)	22.0mm 0.25mm	25.0mm 0.25mm	25.0mm 0.25mm	32.0mm 0.25mm	32.0mm 0.25mm
C	M5 x 0.8	M6 x 1.0	M6 x 1.0	M8 x 1.25	M10 x 1.5



Studs

	S1	S2	S4	S6	S8	S9
M	M8 x 1.25	M10 x 1.5	M10 x 1.5	M5 x 0.8	M6 x 1.0	NO THREAD
L	12mm	15mm	12mm	10mm	10mm	



Clevis Forks

	C1	C2	C3	C4
E (+/-)	5.0mm 0.25mm	6.0mm 0.25mm	8.0mm 0.25mm	10.0mm 0.25mm
M (+/-)	5.14mm 0.12mm	6.15mm 0.12mm	8.15mm 0.12mm	10.15mm 0.12mm
L (+/-)	20.0mm 0.5mm	24.0mm 0.5mm	32.0mm 0.5mm	37.0mm 0.5mm
C	M5 x 0.8	M6 x 1.0	M8 x 1.25	M10 x 1.5



Steel Ball Joints

	B1	B2	B3	B4	B5	B6	B8	B9
J (+/-)	12.0mm 0.5mm	12.0mm 0.5mm	12.0mm 0.5mm	13.0mm 0.2mm	13.0mm 0.2mm	16.0mm 0.25mm	NO PIN	NO PIN
K (+/-)	9.0mm 0.3mm	12.5mm 0.5mm	12.5mm 0.5mm	16.5mm 0.5mm	16.5mm 0.5mm	20.0mm 0.5mm		
G	M5 x 0.8	M8 x 1.25	5/16" UNC	M8 x 1.25	5/16" UNC	M10 x 1.5		
L (+/-)	18.0mm 0.25mm	18.0mm 0.25mm	18.0mm 0.25mm	30.0mm 0.25mm	30.0mm 0.25mm	35.0mm 0.3mm	18.0mm 0.25mm	30.0mm 0.25mm
C	M6 x 1.0	M6 x 1.0	M6 x 1.0	M8 x 1.25	M8 x 1.25	M10 x 1.5	M6 x 1.0	M8 x 1.25

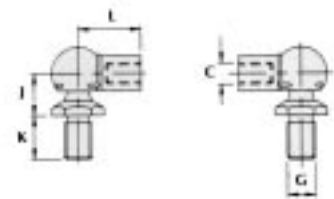

Zinc Eyes

	Z1	Z2	Z3	Z4	Z5
E (+/-)	6.1mm 0.05mm	8.3mm 0.1mm	10.3mm 0.1mm	8.3mm 0.1mm	10.3mm 0.1mm
M (+/-)	10.0mm 0.12mm	10.0mm 0.12mm	10.0mm 0.12mm	10.00mm 0.12mm	10.00mm 0.12mm
L (+/-)	21.0mm 0.25mm	21.0mm 0.25mm	21.0mm 0.25mm	21.0mm 0.25mm	21.0mm 0.25mm
C	M6 x 1.0	M6 x 1.0	M6 x 1.0	M8 x 1.25*	M8 x 1.25*

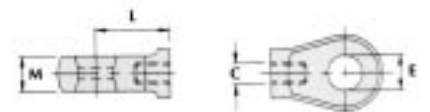

* Cannot be used on 14-28